

Lawrence Berkeley National Laboratory

BioEPIC

Environmental Planning & Review Process

Jeff Philliber

For Berkeley Lab CAG Meeting

September 2019

Environmental Planning

Site and Environmental Planning

Environmental Planning: Siting

- Central, developed location
- Insulated from neighbors
- “Brownfield” redevelopment site
- Proximity to transit, utilities, services

Environmental Planning: Siting

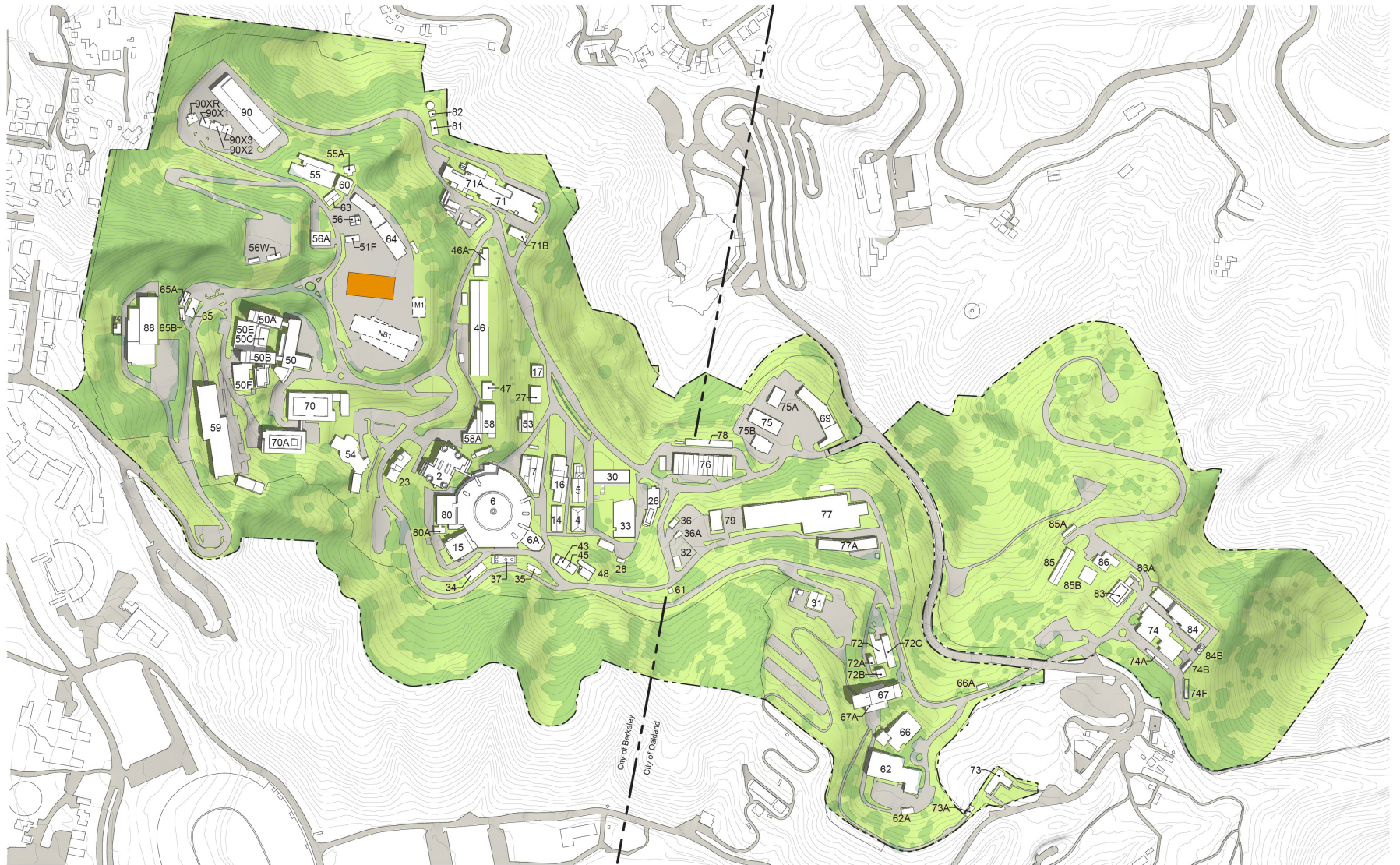

Environmental Planning: Siting

- Central, developed location
- Insulated from neighbors
- "Brownfield" redevelopment site
- Proximity to transit, utilities, services

Environmental Planning: Siting

Land Use Compatibility and Scale

Siting Considerations

Bayview Planning Area

- Existing setting + project
- Land use compatibility
- Historic scale
- Planning scale
- Project scale



Siting Considerations

Bayview Planning Area

- Existing setting + project
- Land use compatibility
- Historic scale
- Planning scale
- Project scale



Siting Considerations

Bayview Planning Area

- Existing setting + project
- Land use compatibility
- Historic scale
- Planning scale
- Project scale



Siting Considerations

Bayview Planning Area

- Existing setting + project
- Land use compatibility
- Historic scale
- Planning scale
- Project scale

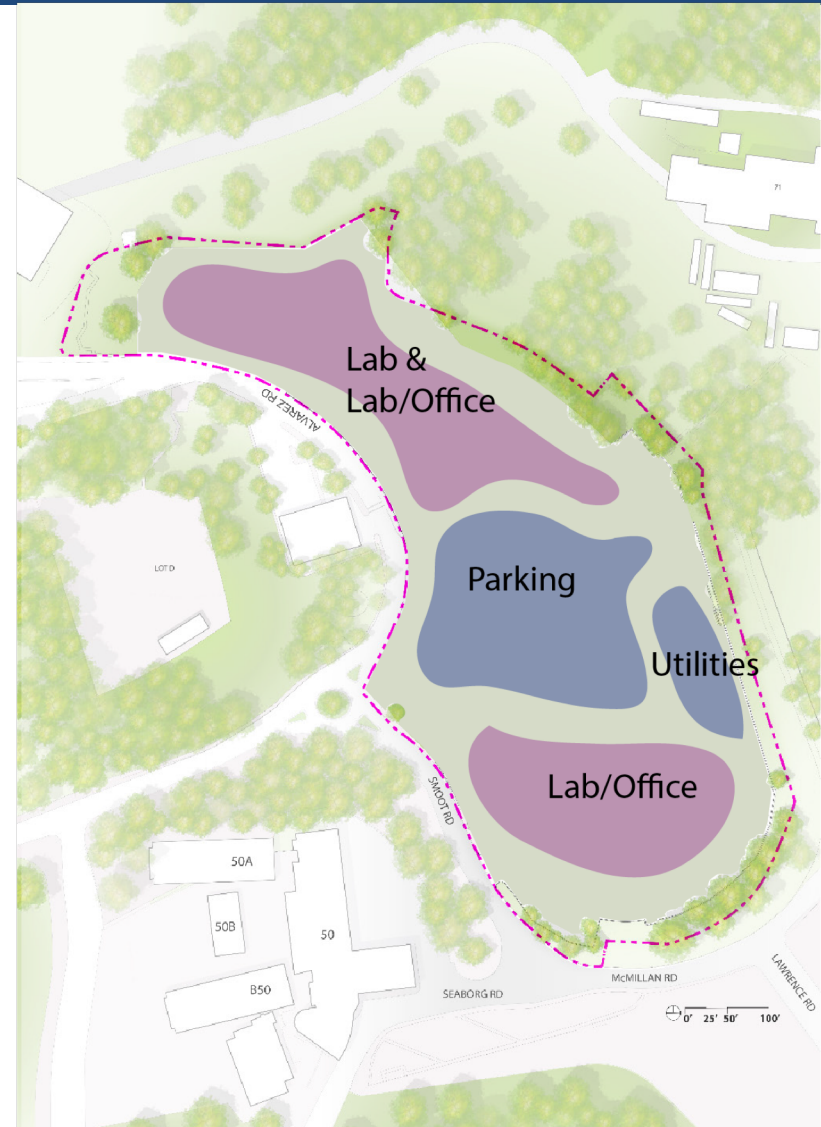

Siting Considerations

Bayview Planning Area

- Existing setting + project
- Land use compatibility
- Historic scale
- Planning scale
- Project scale

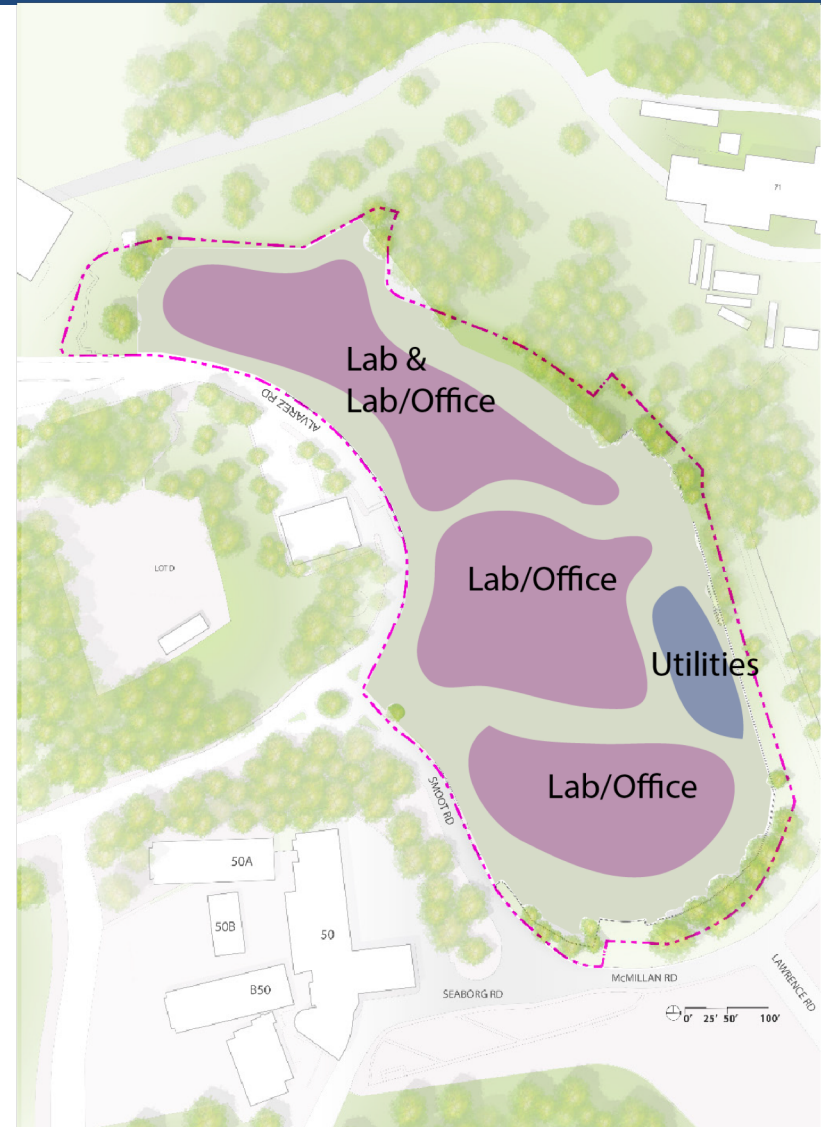

Siting Considerations

Bayview Planning Area

- Existing setting + project
- Land use compatibility
- **Historic scale**
- Planning scale
- Project scale

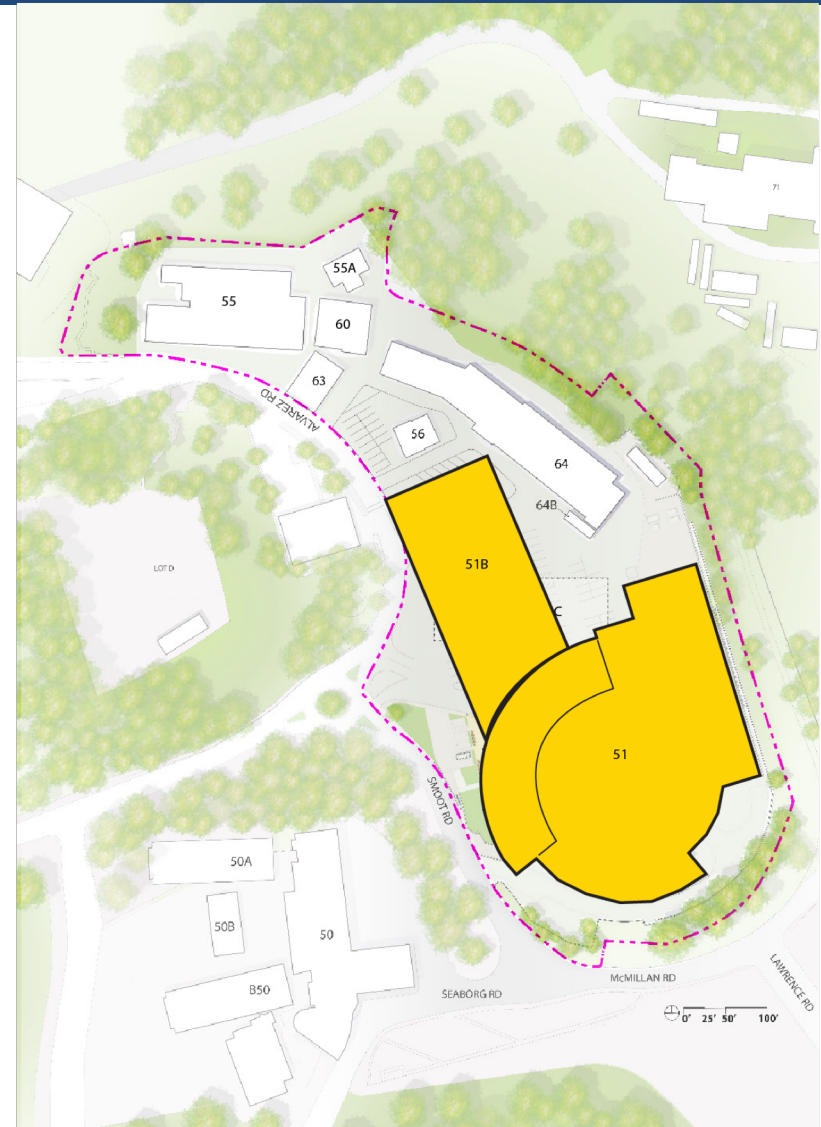

Siting Considerations

Bayview Planning Area

- Existing setting + project
- Land use compatibility
- Historic scale
- Planning scale
- Project scale

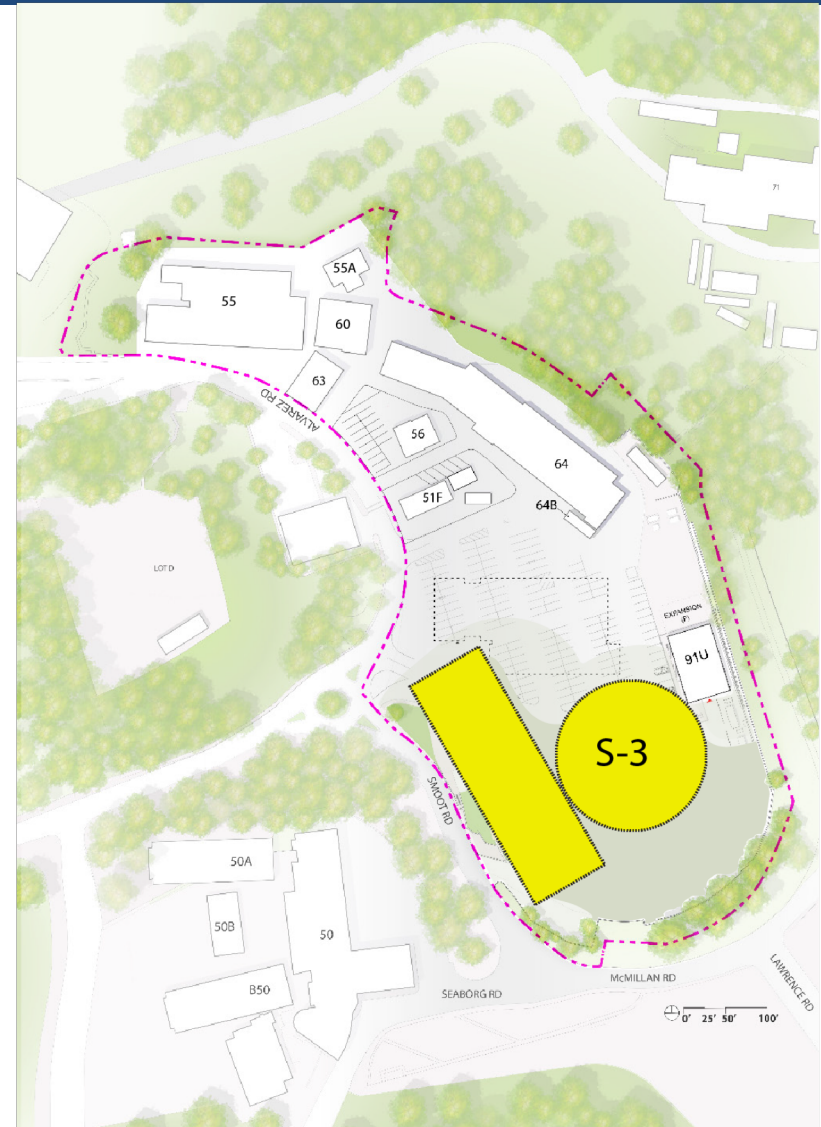

Siting Considerations

Bayview Planning Area

- Existing setting + project
- Land use compatibility
- Historic scale
- Planning scale
- Project scale

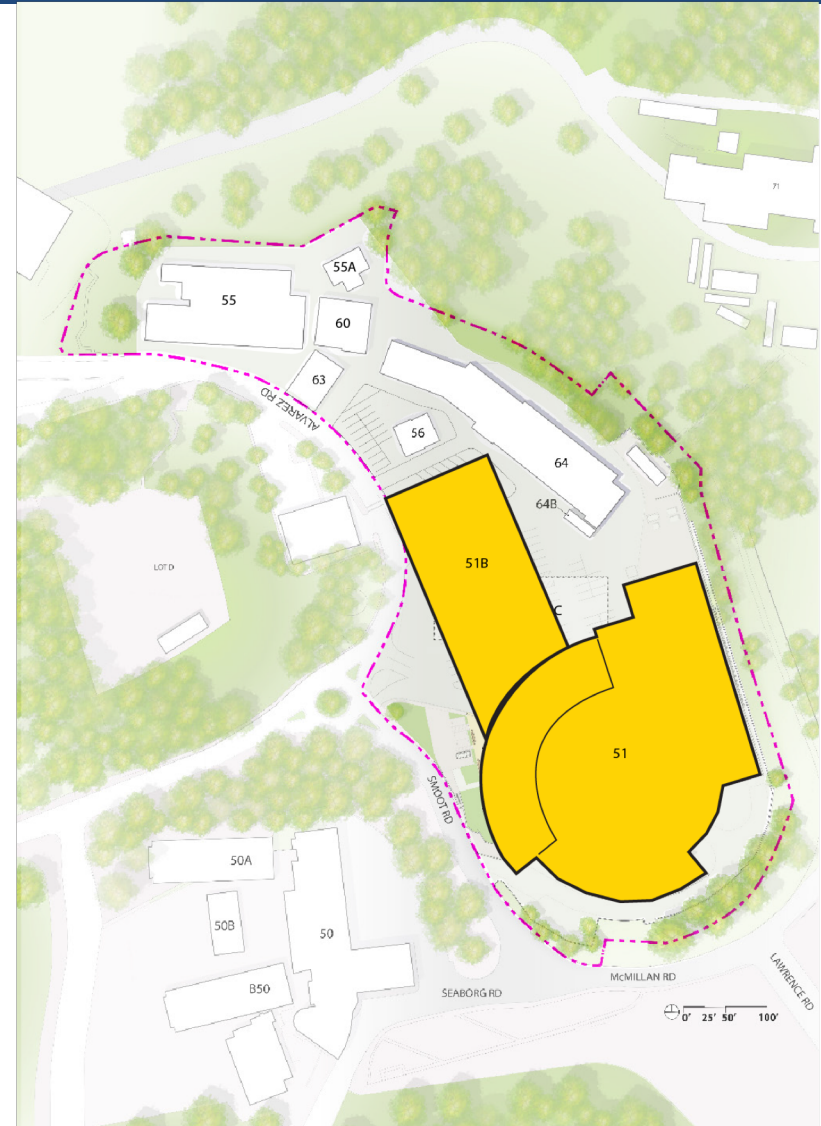

Siting Considerations

Bayview Planning Area

- Existing setting + project
- Land use compatibility
- Historic scale
- Planning scale
- Project scale

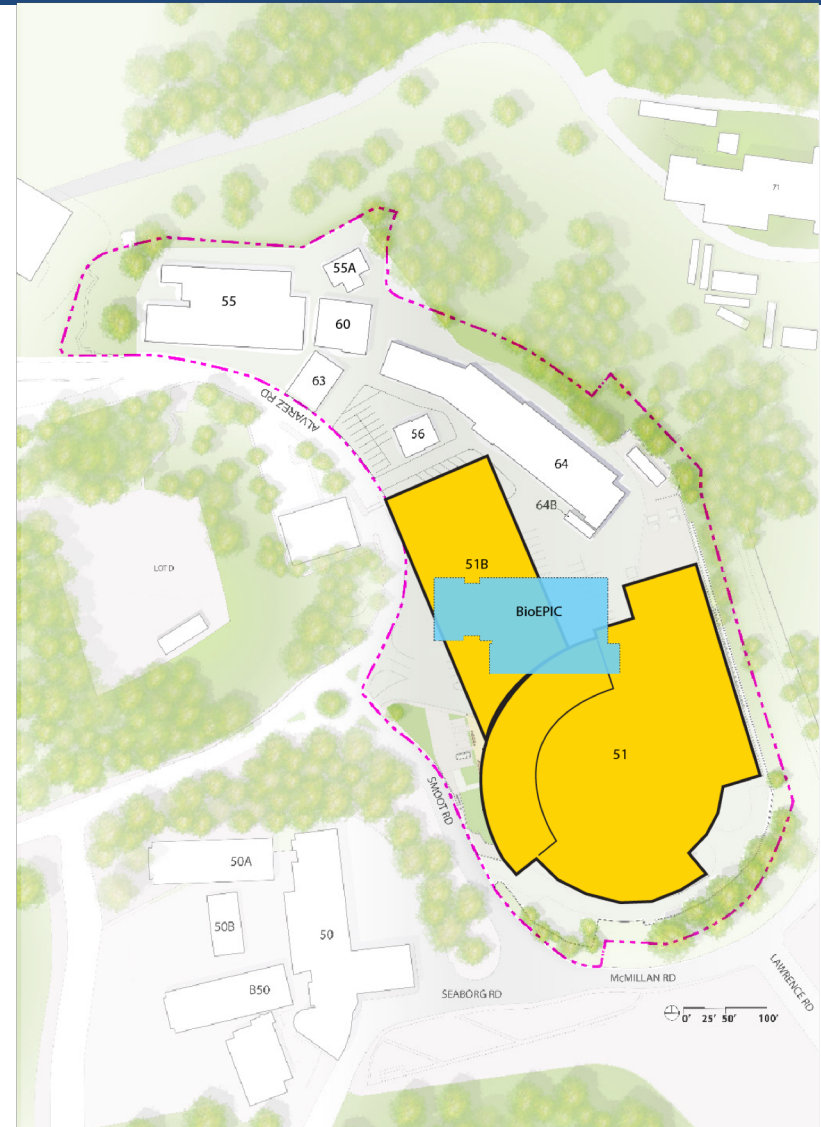

Siting Considerations

Bayview Planning Area

- Existing setting + project
- Land use compatibility
- Historic scale
- Planning scale
- Project scale

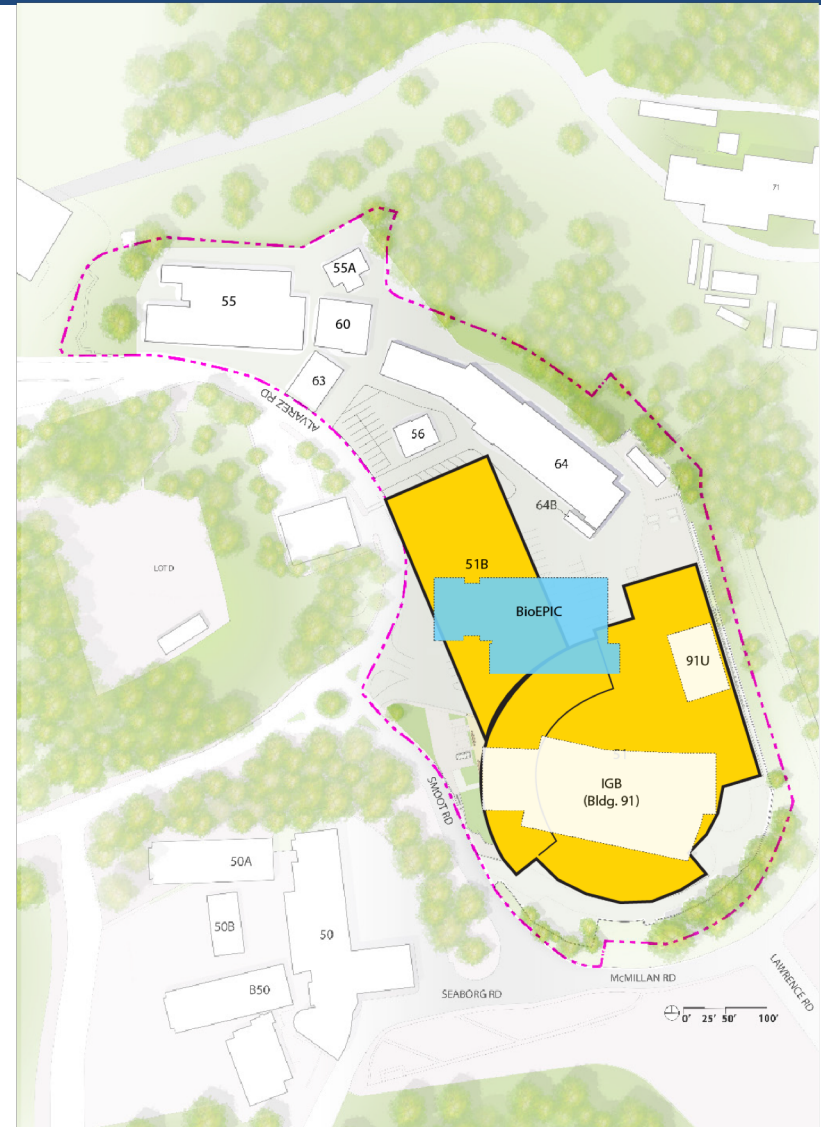

Environmental Analysis

Environmental Analysis

Environmental Analysis: Operations

- **Biological resources**
- **Water quality**
- **Transportation and traffic**
- **Utilities and sustainability**
- **Aesthetics / visual quality**

Environmental Analysis: Operations

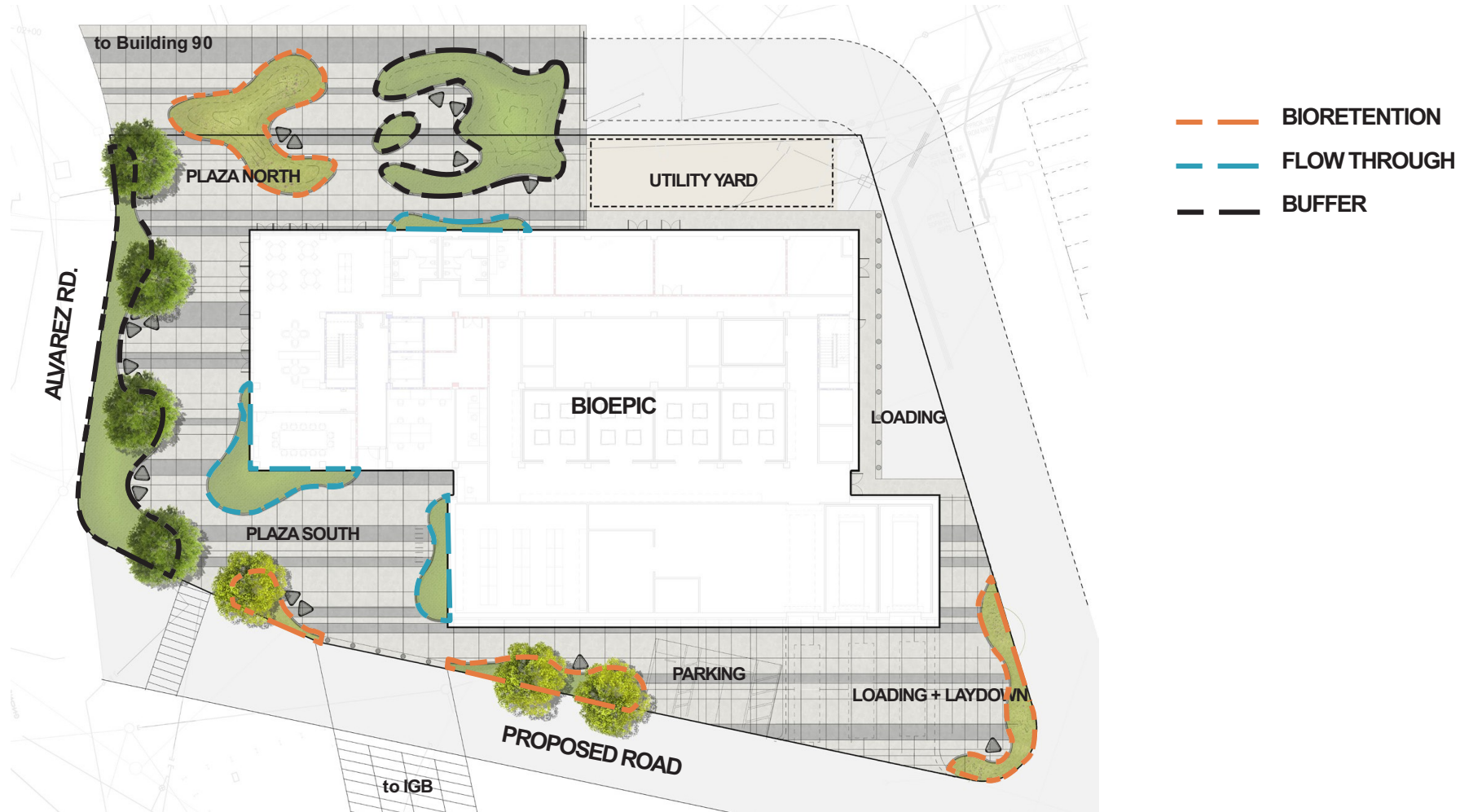

Environmental Analysis: Operations

PLANTING

BIORETENTION & FLOWTHROUGH PLANTING

TREES AND SHRUBS



PERENNIALS & GROUNDCOVER

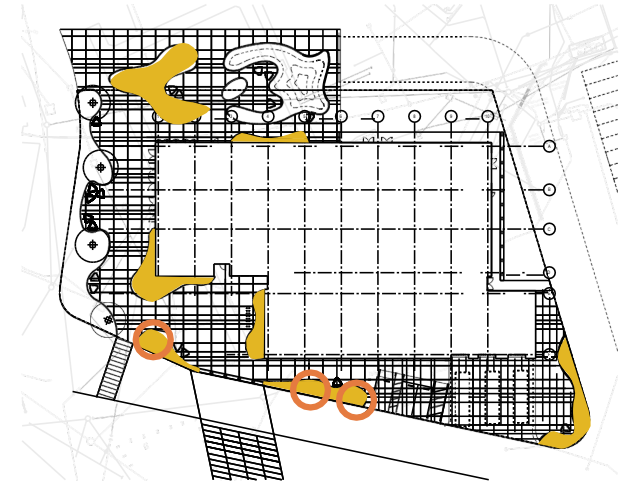
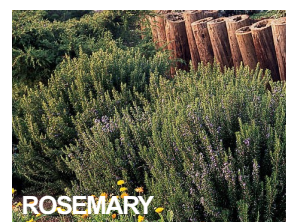

GRASSES

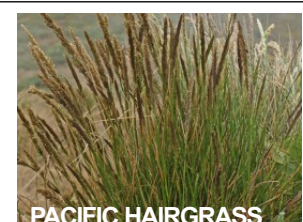

Environmental Analysis: Operations

- Biological resources
- Water quality
- Transportation and traffic
- Utilities and sustainability
- Aesthetics / visual quality

Environmental Analysis: Operations

- Biological resources
- Water quality
- Transportation and traffic
- Utilities and sustainability
- Aesthetics / visual quality

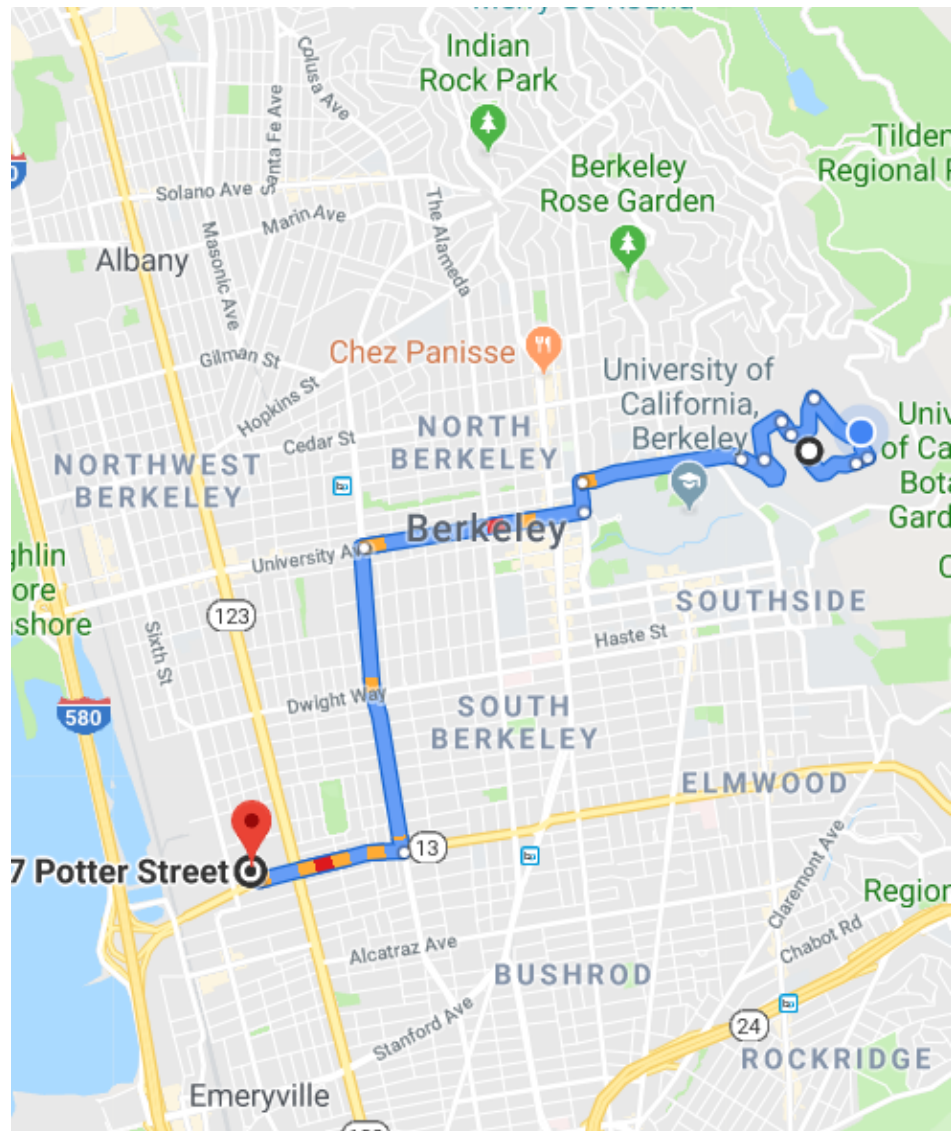

Environmental Analysis: Operations

- Biological resources
- Water quality
- Transportation and traffic
- Utilities and sustainability
- Aesthetics / visual quality

Environmental Analysis: Operations

- Biological resources
- Water quality
- Transportation and traffic
- Utilities and sustainability
- Aesthetics / visual quality

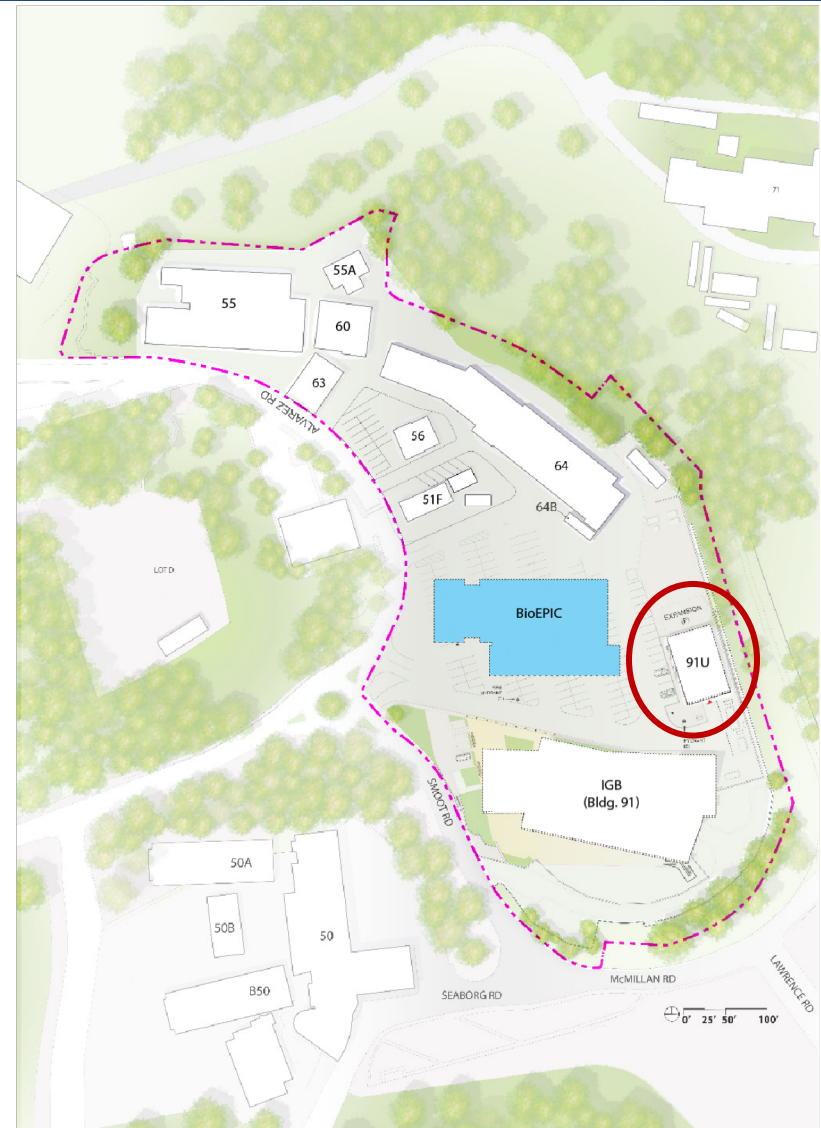

Environmental Analysis: Operations

- Biological resources
- Water quality
- Transportation and traffic
- Utilities and sustainability
- Aesthetics / visual quality

Environmental Analysis: Operations

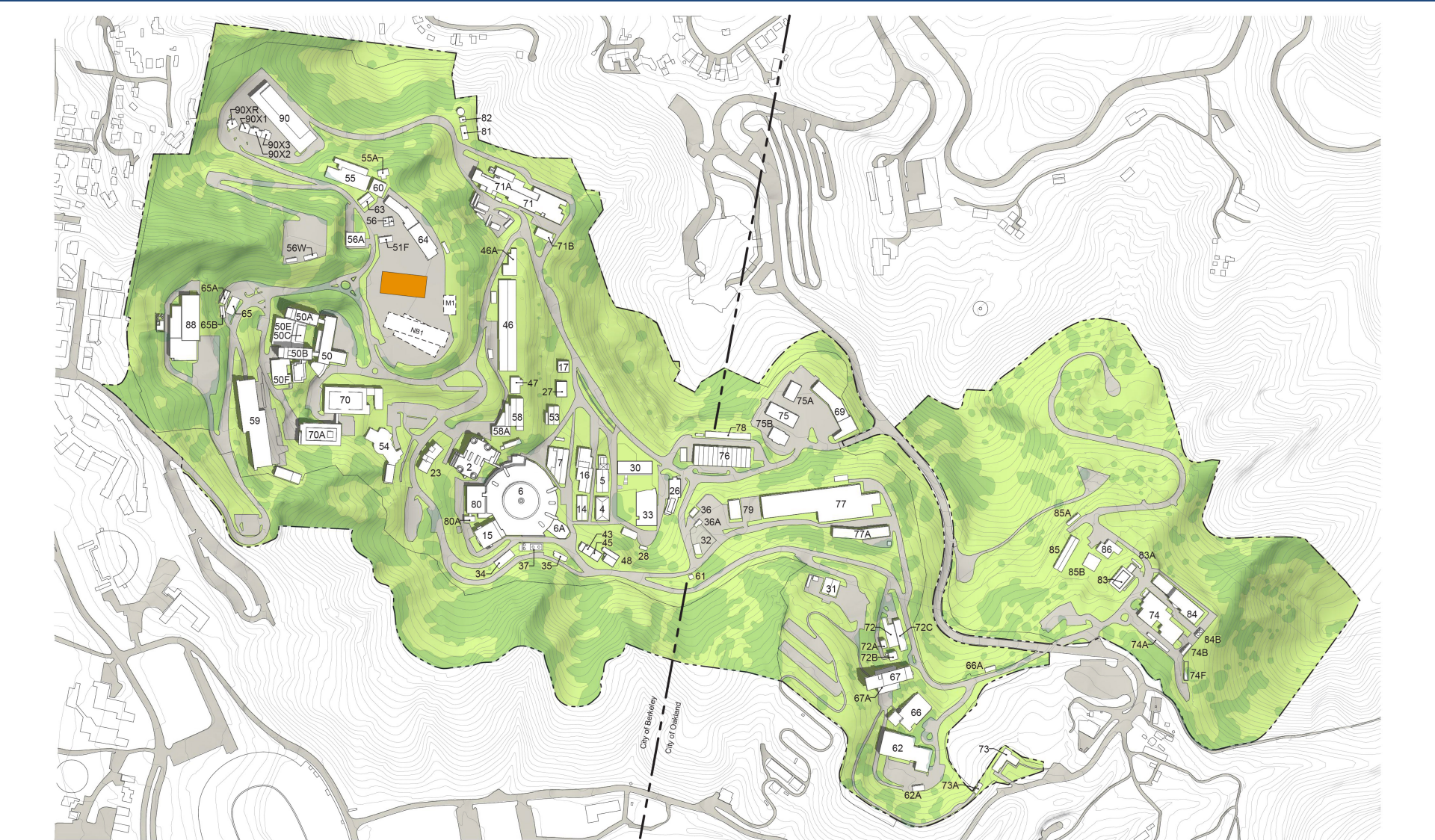

Environmental Analysis: Operations



Environmental Analysis: Operations



Environmental Analysis: Operations



Environmental Analysis: Construction

- Mitigation monitoring and best management practices
- Air quality management
- Stormwater controls
- Truck trip management
- Noise monitoring

Environmental Analysis: Construction

- Mitigation monitoring and best management practices
- Air quality management
- Stormwater controls
- Truck trip management
- Noise monitoring



Environmental Analysis: Construction

- Mitigation monitoring and best management practices
- Air quality management
- Stormwater controls
- Truck trip management
- Noise monitoring



Environmental Analysis: Construction

- Mitigation monitoring and best management practices
- Air quality management
- Stormwater controls
- Truck trip management
- Noise monitoring



Environmental Analysis: Construction

- Mitigation monitoring and best management practices
- Air quality management
- Stormwater controls
- Truck trip management
- Noise monitoring



Environmental Analysis: Construction

- Mitigation monitoring and best management practices
- Air quality management
- Stormwater controls
- Truck trip management
- Noise monitoring

Environmental Analysis: Construction

LBLN Construction Truck Traffic

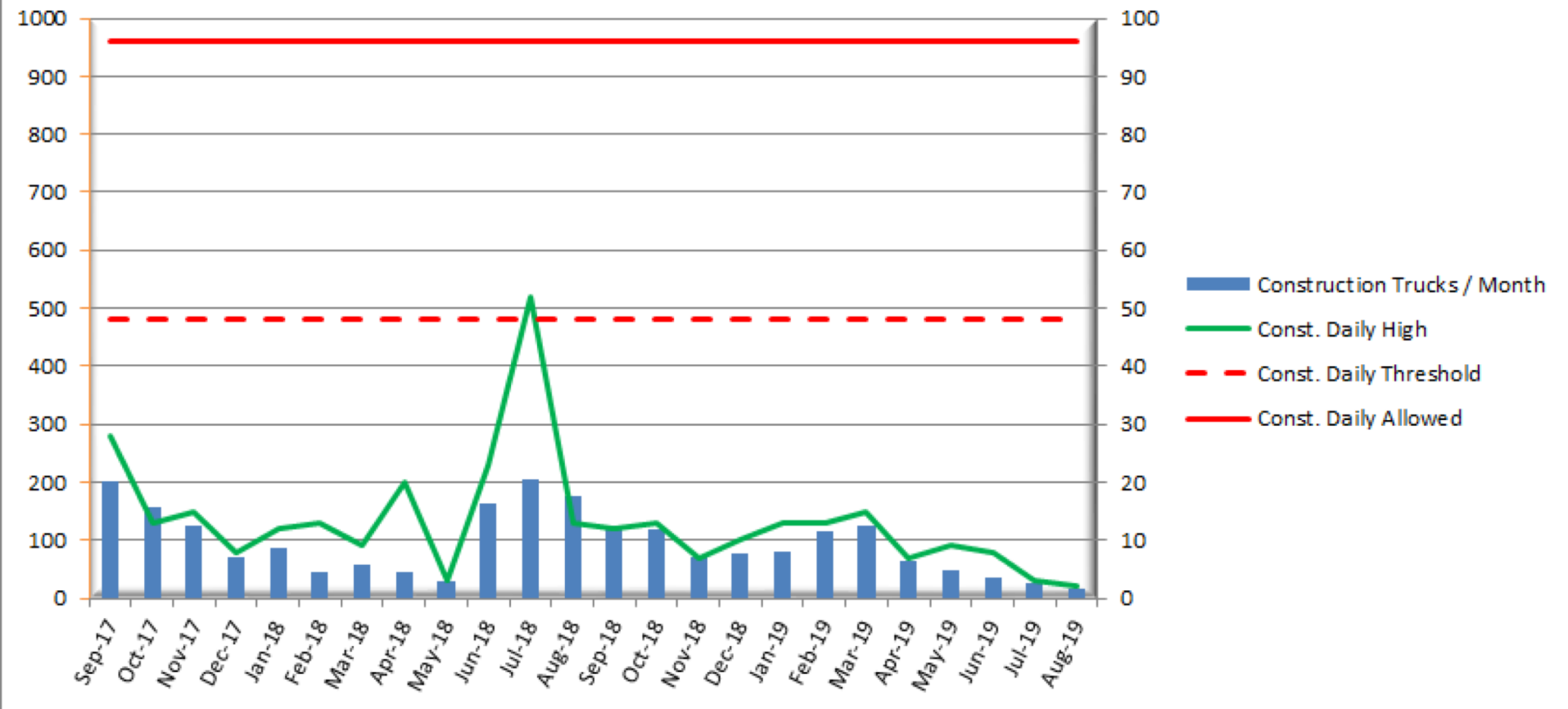

Environmental Analysis: Construction

- Mitigation monitoring and best management practices
- Air quality management
- Stormwater controls
- Truck trip management
- Noise monitoring

Environmental Review

Similar to IGB review and approvals:

NEPA

- **February 2019 DOE decision**

CEQA

- **November 2019 UC Regents decision**

Questions?